

HIGH STANDARD, INC.

MANUFACTURING/MARKETING
FIREARMS

31 PRESTIGE PARK CIRCLE, EAST HARTFORD, CONNECTICUT 06108 • (203) 289-9531

PARTS SCHEMATIC 10-X

MILITARY GRIP STYLE

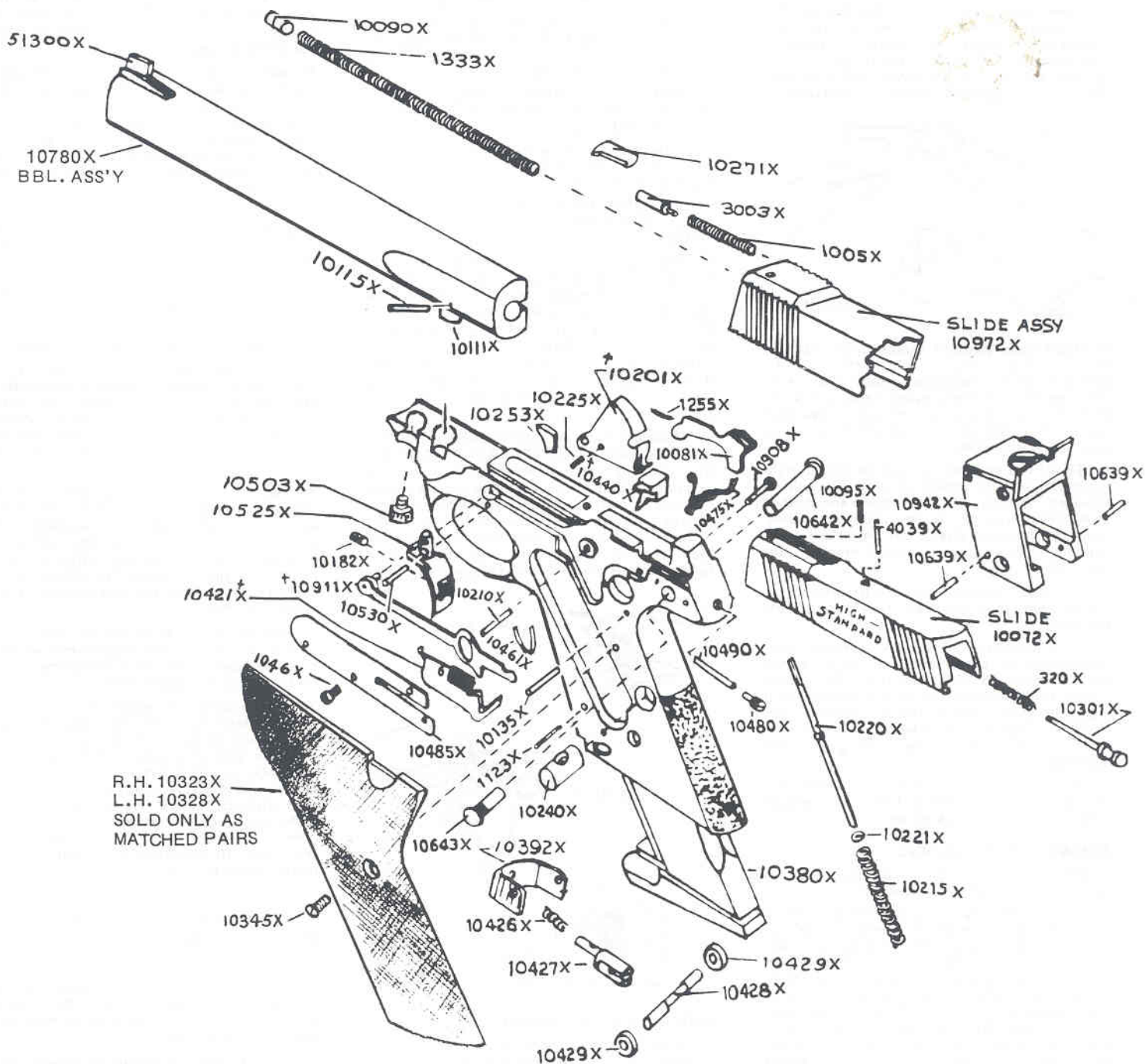

† MUST BE FACTORY FITTED

INSTRUCTIONS FOR OPERATION AND CARE OF YOUR HIGH STANDARD PISTOL

DISASSEMBLY: SCREW TAKEDOWN MODELS NEVER PROCEED TO DISASSEMBLE BEFORE UNLOADING.

1. To remove magazine, hold the gun with one hand, cup the palm of the other hand under the grip, grasp the magazine catch between thumb and forefinger and push forward. The magazine will safely drop into your cupped palm.

2. Point the gun in a safe direction. (Pull back slide and lock in place by pushing up slide lock lever. At the same time examine gun to make certain no cartridge remains in the chamber.)

All models that have the rear sight base bracket fastened to frame. Point the gun in a safe direction, hold the gun in one hand, keeping your trigger finger out of the trigger guard. Use other hand to grasp the serrations at the front of the slide firmly between thumb on one side and fore-and middle finger on the other side, then push the slide rearward and move slide lock lever up. Inspect the chamber again to be sure it is empty.

3. Move safety button upward to ON position. This movement locks hammer and sear, disconnects the trigger and completely separates sear bar from sear. Even if the trigger is pulled accidentally the sear bar cannot reach the sear. This means complete protection for the shooter.

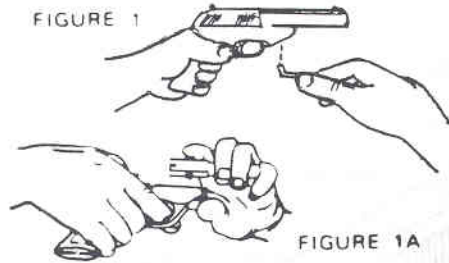

4. Right hand shooters should grasp pistol as shown in Fig. 1. Gun is held in left hand. Insert short end of takedown wrench into opening at the front of trigger guard (Front of frame). Wrench must engage socket cap screw head firmly. Pull long end of wrench toward you until screw is loosened.

NOTE: If left handed, gun will be held in right hand and wrench loosening sequence will be repeated. Wrench will be grasped and pushed away from you to loosen takedown screw. Remove takedown screw. Lift barrel out of its bedding with a straight upward motion. (See Fig. 1A).

5. Pull back locked slide a short distance to release slide lock and ease slide forward off the frame.

6. If it is desired to uncock hammer, after disassembly of barrel and slide, move safety button down to OFF position. Then press thumb firmly against top of the hammer, pull gradually against trigger and ease hammer forward. It is not recommended to allow the hammer to snap forward when the gun is disassembled.

When removing right-hand grip, be careful not to lose Slide Lock Spring (see part number) 1255 on front page illustration).

ASSEMBLY AND LOADING

1. Cock hammer by thumb pressure if it has been uncocked during disassembly.

2. Replace slide by lining up with grooves on frame. Retract slide to most rearward position and lock in place by pushing up slide lock lever. Now grasp frame and slide as in Fig. 1 with right hand. Grasp barrel with left hand. Make certain that barrel is firmly locked in frame, Insert takedown screw into front of frame and tighten snugly. After the barrel is replaced in the frame, always snap the slide a few times against the barrel to securely seat the barrel lock plunger.

3. Trigger pull: For pistols with SEAR adjustment. To make pull heavier, turn Sear Adjustment Screw (Part Number 10480), located in rear of frame, in a clockwise direction. To lighten pull to individual preference, turn screw in a counterclockwise direction. Lightest pull is obtained when screw is flush with surface of frame.

NOTE: Sear Adjustment Screw is factory set to minimum pull. Each half turn or click or screw equals the addition or subtraction of 1½ ounces.

4. Assure yourself once more that the gun is completely empty (both chamber and magazine). To obtain the most positive let off, place the hammer in cocked position by retracting slide. Let trigger stop screw protrude far enough from the back of the trigger that, when the trigger is pulled, the hammer will not fall. Then, while exerting pressure on the trigger, turn screw counter clockwise until the hammer falls. Turn the screw an additional ¼ turn counter clockwise.

5. Push safety upward into ON position.

6. Load magazine by grasping as shown in Figure 2, and gradually depress the magazine button as each cartridge is inserted-RIM END FIRST - through the front.

HIGH-STANDARD PISTOLS ARE FACTORY TESTED WITH ALL STANDARD BRANDS OF AMMUNITION.

7. Slide must be retracted before fully loaded magazine can be inserted so far that magazine catch snaps in place.

PULL SLIDE BACK, AND ENGAGE SLIDE LOCK LEVER MANUALLY TO HOLD SLIDE OPEN.

8. Grasp pistol in one hand and with the other pull or push the slide as far back as it will go. See Figure 3. Release slide and it will strip a cartridge from magazine and feed it into barrel chamber. Gun is now ready to fire by releasing safety and pulling trigger.

THIS IS A SEMI-AUTOMATIC PISTOL AND TEN SUCCESSIVE SHOTS MAY BE FIRED BY SIMPLY PULLING THE TRIGGER FOR EACH SHOT.

9. Make gun safe. ALWAYS CARRY PISTOL WITH SAFETY ON-UNTIL READY TO USE. This safety is located at an accessible thumb-tip position so that it may be easily released when pistol is pointed at target. When loading a single cartridge into chamber, be sure slide is locked in open position with slide lock. Because slide lock lever is designed for easy release, it is recommended that slide also be held by hand.



FIGURE 2

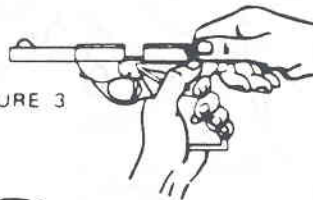

FIGURE 3



CORRECT SIGHT PICTURE

CARE AND MAINTENANCE:

1. If, after extensive shooting, cleaning becomes necessary, the use of kerosene or any other good cleaning solution is recommended.

2. In cleaning the muzzle, an old toothbrush or similar brush should be used. If mud or foreign matter should enter the bore, a stiff bristle brush or copper wire brush for .22 caliber guns should be used. After brush has removed all mud and foreign matter, the bore should be swabbed with flannel patches attached to a .22 caliber cleaning rod. Patches should be moistened with a good gun oil and the swabbing of the bore should be continued until the patches come out clean.

3. It is recommended that the magazine be completely immersed in kerosene every 500 to 800 rounds. (Make certain that there is no water in the container. Where kerosene is stored in open containers atmospheric moisture sometimes accumulates in the bottom of the container. Thus parts are actually being immersed in water and not kerosene). Remember, a dirty magazine may prevent a cartridge from rising fast enough, so that the slide may close on an empty chamber.

4. A few drops of light-bodied oil should be put into the action from time to time. When this is done, it is suggested the slide be removed for better dispersion.

5. Before first firing the gun, make certain that the bore is clean and free from any obstruction. If the bore has been filled with grease for extended storage, all grease should be removed before shooting by swabbing out the bore with a .22 caliber borecleaning tool. Also remove any excessive accumulation of oil from inside the barrel.

6. The entire gun should be wiped dry of kerosene or cleaning solution with a clean absorbent cloth and the surfaces should be wiped with a lightly-oiled patch.

7. For best results in rust prevention only gun oils containing silicone should be used.

8. Avoid using heavy-bodied oils. No animal or vegetable oils should ever be used on guns.

9. If the gun is used in climates where extreme cold prevails, powdered graphite should be substituted for oil in lubricating the internal mechanism. In moist climates the gun should be cleaned more frequently and preferably stored in a container treated with silicone to prevent rust.

All Supermatic Pistols are equipped with ultra-modern micrometer rear sights with oversize, easily adjustable windage and elevation knobs. A positive sighting system with audible clicks and dependable calibrations Extra-wide, square-notch leaf plus undercut frontblade with serrated ramp give the sharpest picture under all range conditions.

To elevate the point of impact (gun shooting low) turn the elevation adjustment screw in a counterclockwise direction. This screw is located on the top of the rear sight leaf.

To move point of impact to the right (gun shooting left), turn windage adjustment screw in clockwise direction. This screw is located on the right side of the rear sight base. For easy reference for any desired setting, both windage and elevation screw knobs are clearly indexed with distinct, legible figures and calibrations. Sight leaf shows direction of desired movements. For each turn of micrometer screws there are 10 calibrations - each calibration marked by a definite click.

USE A SCREWDRIVER WHEN MAKING SIGHT ADJUSTMENTS.

In dry firing the pistol in practice, it is best to first insert a dummy cartridge or fired case into the chamber. This will prevent damage to the firing pin and the barrel.

These guns will fire regular or hi-velocity .22 L.R. caliber ammo.

FOR TOP PERFORMANCE: Clean magazine with kerosene or other dependable solvent after every 300 rounds