

J.C. Higgins

MODEL 20
PUMP ACTION SHOTGUN
12 and 16 GAUGE



**J. C. Higgins Guns are sold ONLY by Sears, Roebuck and Co.
and Simpsons-Sears Limited**

MODEL 20

Here is the fastest selling 12 gauge pump shotgun on the market . . . because this one gun is ideal for *all* kinds of shooting at *all* hunting ranges! The J. C. Higgins Model 20 offers more desirable features than any shotgun in America sold at such a low price.

A "free-falling" action combined with an extra-short (3½") pump stroke provide the fastest pump action we know of — that means faster firing and more game! The Model 20 is "triple-safe", too, with an automatic trigger lock, double locked bolt, and trigger safety.

Perfect balance and a comfortable *choice-grained walnut finish stock* make this shotgun easy to handle as well as fast. The stock fore-end is semi-beavertail shape to keep fingers away from barrel heat. *A sturdy rubber recoil pad and silver nameplate are included on deluxe guns.* The barrel is permanently interlocked with the receiver for perfect alignment, and is proof-tested to withstand pressures far greater than regular ammunition can give.

J. C. Higgins Model 20 is available with an adjustable Choqe device and Ventilated Rib. Choqe device provides a variety of shot pattern for different ranges and game, and will reduce barrel whip, muzzle blast and recoil up to 60%.

CLEANING & LUBRICATING

Exclusive use of J.C. Higgins ammunition practically eliminates any need for barrel cleaning. Should powder residue or any dirt accumulate in the barrel, however, it can easily be removed.

Open the action fully, rest the heel of the stock on the floor and hold the gun barrel near the muzzle with the left hand. Push a brass cleaning brush soaked in Nitro solvent through the muzzle end, and work it up and down throughout the entire length of the bore. Follow this by wiping the bore with clean patches until the last one comes out unsoiled. A light protective film of oil may be applied with a patch if desired.

A J. C. Higgins Shotgun Cleaning Kit (available at any Sears' Store or from the catalogue) includes all of the necessary items for easy cleaning of your shotgun. Another piece of valuable equipment is a J. C. Higgins Silicone Cloth which will completely protect outside surfaces of the gun from any rust due to finger prints or moisture by rubbing "once-over-lightly".

Periodically, dirt and fouling should be removed from the bolt, extractors, and other operating parts. This should be done with a tooth brush soaked in Nitro solvent (included in J. C. Higgins Cleaning Kits). Following this, these parts should be wiped dry and oiled lightly.

Your Model 20 is treated with new siliconized and polarized oil. This exclusive, patented process gets down into the pores of the steel and protects against perspiration and other corrosive elements which cause rust. This oil makes J. C. Higgins guns the most rust resistant of any guns you can buy. It gives the best lubrication of any oil tested. And it protects and beautifies stock and forearm.

OPERATING INSTRUCTIONS

For trouble free operation clean heavy protective oils from your shotgun before firing. After cleaning, coat parts lightly with light gun oil. For protection your shotgun also should be cleaned and oiled lightly after shooting and before storage. Also, with an adjustable choqe gun, it is wise to turn choqe cap to improved cylinder setting if you intend to store the gun for extended periods.

CAUTION!

Don't put a 20 gauge shell in a 12 Gauge gun.

The most certain way to bulge or rupture the barrel is to drop a 20 gauge shell into a 12 gauge chamber. The rim of the 20 gauge shell will catch at the bottom of the chamber and will not fall clear through the barrel. A 12 gauge shell can be loaded behind the 20 creating a serious hazard to yourself and the gun. For safety's sake do not carry 20 gauge shells when handling a 12 gauge gun.

Check Barrel for obstructions before loading and firing. Keep muzzle free from dirt, mud, water and snow or other objects which may find their way into the barrel when not in use.

NOTE:

The choke on your plain barrel gun will be identified either by the words "Full", "Mod", or "Imp. Cyl" next to the chamber identification on the right side of the barrel or with asterisks on the left side of the barrel near the breech just above the forearm as follows:

One Asterisk (*) Full Choke.

Two Asterisk (**) Mod. Choke.

Three Asterisk (***) Imp. Cyl. Choke.

TO MAKE GUN SAFE: Safety is located in guard bow forward of trigger. With hammer cocked push safety bar from left to right until red band is covered. This movement locks trigger and gun cannot be fired. Always lock the trigger when carrying a loaded gun.

TO RELEASE SAFETY: Push safety from right to left exposing red band and gun is ready to fire.

TO LOAD CHAMBER: Open action fully by pulling back on fore-end. If gun is locked, press in action slide release located in rear left side of guard bow. Drop shell in loading port.

TO LOAD MAGAZINE: With the safety locking the trigger, insert shells upward into bottom of receiver and push forward into magazine tube past cartridge stops. Repeat until magazine is full. Magazine normally holds 5 shells, or 2 with 8" plug in magazine.

TO OPERATE: When gun is fired, the action automatically unlocks so that the fore-end slide can be drawn fully back, and then forward. This operation extracts and ejects the fired shell, cocks the hammer and carries loaded shell into chamber. Gun is now loaded, double-locked and ready to fire. Always lock trigger with the safety to prevent accidental firing.

TO REMOVE LOADED SHELL FROM CHAMBER WITHOUT FIRING: Push safety to "on" position. Press in action slide release button and open action slowly until shell is opposite ejection port. Place palm of your hand just over port opening and pull back on fore-end and shell will drop out.

TO REMOVE LOADED SHELLS FROM MAGAZINE: Turn gun over with trigger guard up, barrel pointed to left, and press back left cartridge stop; this releases shell from within magazine. Remove shell and repeat until magazine is empty.

PLUGGING MAGAZINE FOR 3 SHOTS: Remove magazine band screw. Move magazine band to one side. Remove both magazine tube locking screws while holding magazine cap firmly. Remove magazine cap being careful to hold back magazine spring which is under tension. Insert wooden plug and reassemble. This reduces magazine capacity to only 2 shells with one shell in the chamber, allowing 3 shells in gun to comply with game laws in certain states.

DISASSEMBLY

TO REMOVE TRIGGER ASSEMBLY: With drift pin or small screw driver push out trigger lock pin from right to left side of receiver. Lift rear part of trigger guard bow until projection of guard clears stock; then pull up and to the rear.

CARTRIDGE STOP, RIGHT HAND: Disengage right hand cartridge stop from round slot in receiver wall and lift out of receiver.

ACTION SLIDE: Move fore-end rearward until all shoulders of slide are centered in the square cuts in receiver. Then while pulling slide upward move fore-end fully forward. Action bar is now free from slide. Hold slide up, make sure it is disengaged from breech block by moving breech block forward and lift slide out of receiver.

CARRIER AND BREECH BOLT: Push fore-end to rear and slide breech bolt forward inside receiver. Using cartridge stop as tool, disengage the right side of the carrier from hole in receiver. Then disengage left side, and lift carrier out of receiver. With fore-end forward, slide breech bolt fully to the rear, and holding it at the rear, lift up and out of receiver.

ASSEMBLING

1. **BREECH BOLT:** With round side of breech bolt facing receiver opening and with extractors forward, insert into receiver bottom and slide forward.

2. **CARRIER:** Move fore-end fully to the rear, grasp front and sides of carrier, flat side up, slightly squeeze carrier sides slightly, and engage hinge ends in proper holes in receiver.

Raise front end of the carrier, then lower to rest over breech bolt.

3. **SLIDE:** Move breech bolt to the rear, centered in square cuts in receiver. Move fore-end rearward until action bar hook is slightly back of the forward square cut in receiver, place slide over receiver cuts and drop into receiver. (Make sure action bar hook has engaged the corresponding cut in slide).

4. **CARTRIDGE STOP, R. H.:** Insert right hand cartridge stop, with round stud slide into stud opening in receiver.

5. **TRIGGER ASSEMBLY:** With fore-end fully forward and the hammer of the trigger assembly in a cocked position, hold cartridge stop flush with receiver walls, insert front end of trigger guard with guide prongs fitting into guide grooves in receiver walls, push forward and down.

6. **TRIGGER GUARD LOCK PIN:** Push pin into receiver from left to right. (Before attempting to drive in pin, carefully align trigger guard until pin hole shows clear passage).

LEFT HAND SAFETY INSTALLATION

REMOVE RIGHT HAND SAFETY 153-1 AS FOLLOWS:

Hold the gun so that the trigger guard is in the up position.

To remove the *right hand* safety button, push the safety button to the fire position (red band showing). Using a small punch or wire (example: bent paper clip), insert wire thru hole provided in safety button. Depress safety plunger and at the same time apply slight pressure in the "FIRE" direction. Be careful not to lose the small spring-loaded safety plunger.

INSTALL LEFT HAND SAFETY 191-1 AS FOLLOWS:

Insert the *left hand* safety button, with red band first, in hole in trigger guard until it butts against safety plunger. In this operation make sure the safety plunger detents are downward. While holding the safety plunger down, push the safety button over the plunger until the plunger drops into one of the detent notches.

A drop of oil on the plunger will assure a smooth working safety button.

SPECIFICATIONS

	<i>Standard</i>	<i>Deluxe</i>		<i>Standard</i>	<i>Deluxe</i>
GAUGE	12 & 16	12	BARREL LENGTH	27	
CHOKE	Full	Full	WITH ADJ. CHOKE		27
	Modified	Modified	PITCH	1 $\frac{3}{8}$	1 $\frac{3}{8}$
	Adjustable	Adjustable	STROKE (INCHES)	3 $\frac{1}{2}$	3 $\frac{1}{2}$
WEIGHT (lbs.)	Approx. 7 $\frac{1}{2}$	Approx. 7 $\frac{1}{2}$	SIGHT	Brass	Brass
LENGTH OF PULL (INCHES)	14 $\frac{3}{8}$	14 $\frac{3}{8}$		Front Sight	Front Sight
DROP AT COMB (INCHES)	1 $\frac{3}{8}$	1 $\frac{3}{8}$	O.A. LENGTH	47 $\frac{1}{2}$	47 $\frac{1}{2}$
DROP AT HEEL (INCHES)	2 $\frac{1}{4}$	2 $\frac{1}{4}$	PLAIN (INCHES)		
BARREL LENGTH PLAIN (INCHES)	28	28	O.A. LENGTH WITH CHOKE (INCHES)	46 $\frac{1}{2}$	46 $\frac{1}{2}$

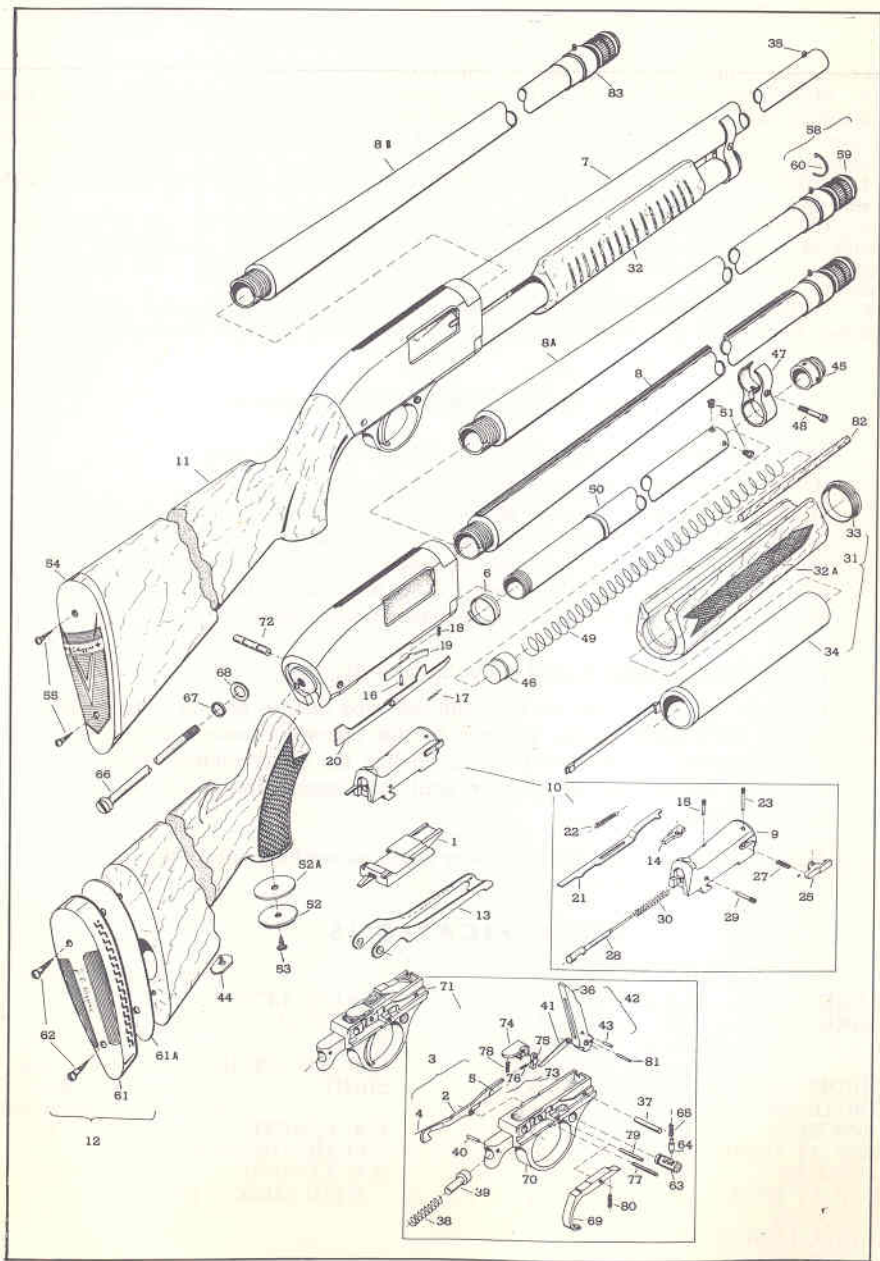

PARTS AND ASSEMBLIES

J. C. Higgins Model 20, 12 and 16 Gauge, Identification numbers 583.2005 (12 Ga.) and 583.2050 (16 Ga.)

One of these numbers is marked on the left side of the barrel just forward of the receiver. Always mention this number when communicating with us regarding the Pump Action Shotgun or when ordering parts. **HOW TO ORDER** — Specify Model number, Identification number, Part number, and Part name. When ordering Barrels, specify choke desired.

Parts marked with a dagger must be fitted by gunsmiths in Sears Mail Order Houses or by outside Gunsmiths.

Where to order Repair Parts — any Sears Retail or Mail Order Store will handle your order. Certain parts are specified for 12 and 16 Gauge. All others are common to both gauges.

REF. NO.	PART NO.	PART NAME	REF. NO.	PART NO.	PART NAME
1	20520	Action Slide 12 Ga.	40	135	Hammer Spring Retaining Pin
1	20600	Action Slide 16 Ga.	41	136	Hammer Strut
2	101B	Action Slide Release Lever	42	131BM	Hammer and Strut Assembly
3	101BM	Action Slide Release Lever Assembly	43	137	Hammer Strut Pin
81	102B	Action Slide Release Lever Oper. Pin	44	178	Initial Plate
4	120	Action Slide Release Lever Spring Rear	45	6708	Magazine Cap
5	103B	Action Slide Release Lever Spring	46	20642	Magazine Follower
6	176B	Action Slide Spring	47	139-1	Magazine Band
7	†20500	Barrel Plain 12 Ga. (Specify Choke)	48	143B	Magazine Band Screw
7	†20604	Barrel Plain 16 Ga. (Specify Choke)	49	145	Magazine Spring
8	†20589	Barrel with Rib and Adj. Choke 12 Ga.	50	146BM	Magazine Assembly
8A	†20588	Barrel Plain with Adj. Choke 12 Ga.	51	147A	Magazine Tube Locking Screws (2)
8B	†20585	Barrel Plain with Adj. Choke 12 Ga.	52	401	Pistol Grip Cap
8B	†20643	Barrel Plain with Adj. Choke 16 Ga.	52A	402	Pistol Grip Cap Trim
9	†20531	Bolt 12 Ga.	53	403	Pistol Grip Cap Screw
9	†20658	Bolt 16 Ga.	54	620	Butt Plate
10	†20533	Bolt Assembly 12 Ga.	55	345	Butt Plate Screws (2)
10	†20683	Bolt Assembly 16 Ga.	61	6751	Recoil Pad
11	6788	Butt Stock Assembly Plain	61A	404	Recoil Pad Trim
12	6786	Butt Stock Assembly Checkered	62	152	Recoil Pad Screws (2)
13	1078M	Carrier Assembly 12 Ga.	63	153-1	Safety Button R.H.
13	20608	Carrier Assembly 16 Ga.	63	191-1	Safety Button L.H.
14	108	Carrier Operating Cam	64	4044	Safety Plunger
15	11125	Carrier Operating Cam Retaining Pin	65	360	Safety Plunger Spring
16	864	Cartridge Stop Pin	66	666	Stock Bolt
17	865	Cartridge Stop Pin Retaining Clip	67	667	Stock Bolt Lock Washer
18	199	Cartridge Stop Spring	68	668	Stock Bolt Washer
19	192	Cartridge Stop L.H. 12 Ga.	69	†6740	Trigger
19	20692	Cartridge Stop L.H. 16 Ga.	70	6758	Trigger Guard
20	111M	Cartridge Stop R.H. 12 Ga.	71	6759	Trigger Guard Assembly
20	20612	Cartridge Stop R.H. 16 Ga.	72	6719	Trigger Guard Retaining Pin
21	20525	Combination Ejector and Extractor 12 Ga.	73	160	Trigger Guard Retaining Pin Spring
21	20615	Combination Ejector and Extractor 16 Ga.	74	†161B	Trigger Lock
22	6720	Ejector and Extractor Spring	75	†162B	Trigger Lock Pawl
23	119	Extractor Hinge Pin R.H.	76	163	Trigger Lock Pawl Spring
25	755	Extractor R.H. 12 Ga.	77	164	Trigger Lock Pin
25	20655	Extractor R.H. 16 Ga.	78	165B	Trigger Lock Spring
27	625	Extractor Spring R.H.	79	166	Trigger Pin
28	773	Firing Pin	80	167B	Trigger Spring
29	124	Firing Pin Retaining Pin	82	180	Wood Plug 8 Inches
30	125	Firing Pin Spring	58	8779	Choke Assembly for BBL. with Rib and Adj. Choke Deluxe
N.I.	728	Forehand Assembly Plain	58	8768	(Includes Element, Cap and Spring)
31	748	Forehand Assembly Checkered			Choke Assembly for BBL. without Rib Deluxe
32	723	Forehand Operating Handle Plain			(Includes Element, Cap and Spring)
32A	799	Forehand Operating Handle Checkered	59	766	Choke Cap 12 Ga.
33	128B	Forehand Operating Sleeve Front Nut	59	11615	Choke Cap 16 Ga.
34	6707	Forehand Operating Tube Assembly	60	11628	Choke Click Spring 12 Ga.
35	130	Front Sight	60	11630	Choke Click Spring 16 Ga.
36	131B	Hammer	83	†11950	Choke Assembly 12 Ga.
37	132	Hammer Hinge Pin			(Includes Cap, Element and Spring) Standard
38	762	Hammer Spring	83	†11953	Choke Assembly 16 Ga.
39	639	Hammer Spring Guide			(Includes Cap, Element and Spring) Standard

Note: N.I., Not Illustrated