

**PARTS LIST FOR**  
**J. C. HIGGINS**  
**MODEL 66**  
**12 GA. AUTOMATIC SHOTGUN**

**MODEL NUMBER**

583.602

This number is the Model Number of your Model 66 Automatic Shotgun. It will be found on the left side of the barrel. Always mention this model number when communicating with us regarding the Shotgun or when ordering parts.

**PRICE LIST REFERENCE**

REFER TO THE DIVISION 6 AUTHORIZED PRICE LIST 583.00 FOR CURRENT SELLING PRICES, AVAILABILITY AND ORDERING INFORMATION.

**Filing Instructions**

File this Parts List immediately after Parts List Number 583.601 in the Division 6 Standard Nomenclature Grey Binder, Volume 2.

**SEARS, ROEBUCK AND CO.—U.S.A.**  
**IN CANADA: SIMPSONS-SEARS, LIMITED**

October, 1958

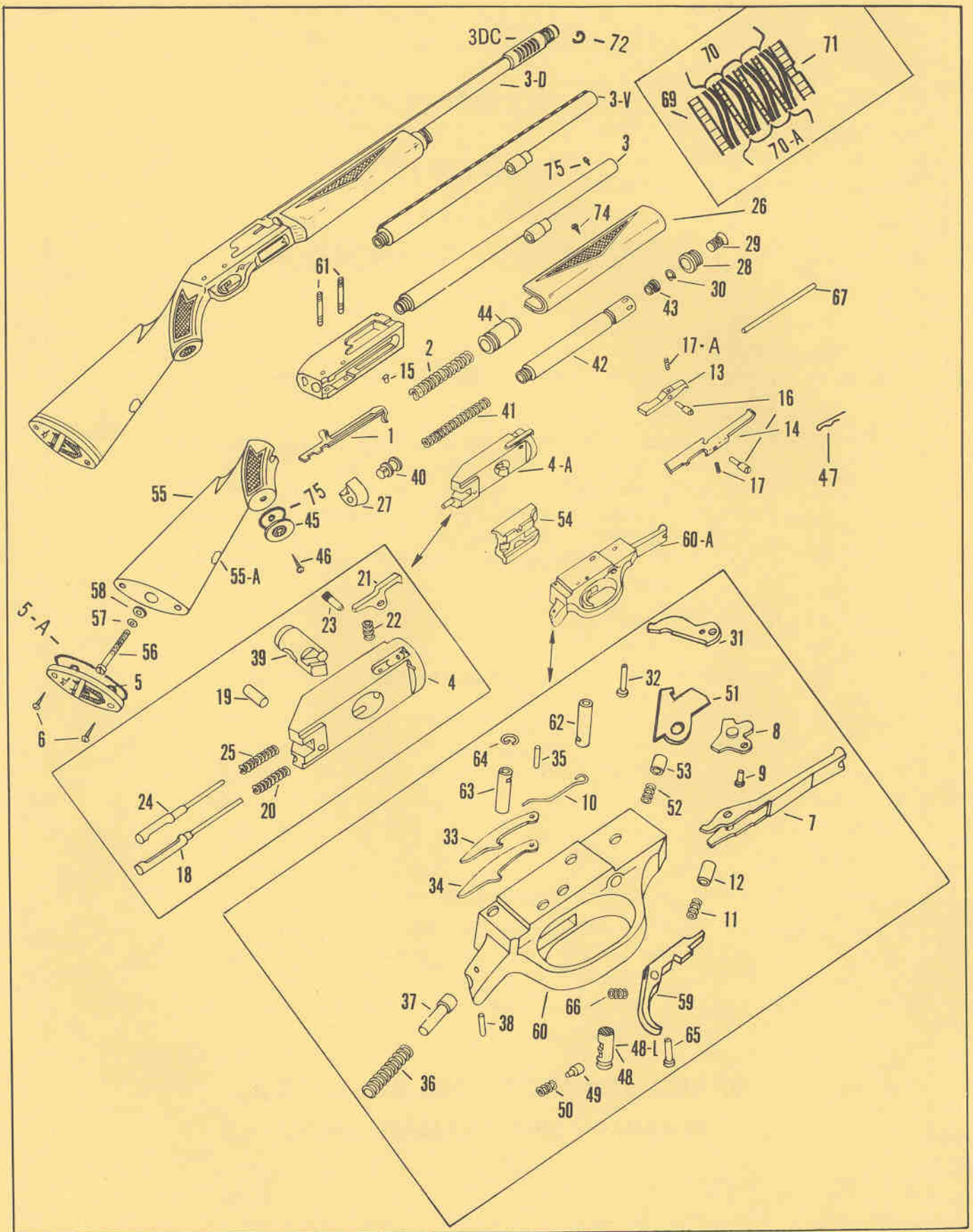

**PARTS LIST FOR**  
**J.C. HIGGINS MODEL 66 12 GAUGE AUTOMATIC SHOTGUN**  
**MODEL NO. 583.602**

WHEN ORDERING REPAIR PARTS, ALWAYS GIVE THE FOLLOWING INFORMATION AS SHOWN IN THIS LIST:

1. THE PART NUMBER.
2. THE PART NAME.
3. THE MODEL NUMBER.
4. THE NAME OF ITEM.

All parts identified with a dagger (†) must be fitted to the gun by gunsmiths in Sears gunshops, or by other qualified gunsmiths. Do not order repair parts by key numbers, always use the part number.

REF. NO.	PART NO.	PART NAME	REF. NO.	PART NO.	PART NAME
1	757	†Action Bar	42	647	Magazine Tube
2	733	†Action Spring	43	648	Magazine Tube Cap
3	6601	†Barrel and Cylinder Assy. Plain	44	651	Piston
3V	6602	†Barrel and Cylinder Assy. with Ventilator Rib	45	401	Pistol Grip Cap
3D	6603	†Barrel and Cylinder Assy. Deluxe with Choke Control and Ventilator Rib	46	403	Pistol Grip Screw
3DC	769	†Choke Assy. (See Note)	47	865	Cartridge Stop Pin Ret. Clip
4	756	†Bolt	48	659	Safety Button, R.H.
4A	785	†Bolt Assy.		751	Safety Button, L.H.
5	620	Butt Plate	49	605	Safety Spring Plunger
5A	792	Butt Plate Trim	50	155B	Safety Plunger Spring
6	345	Butt Plate Screw	51	873	Escapement Hook
7	608	Cartridge Lifter	52	649	Sear Spring
8	677	†Cartridge Lifter Actuator Assy.	53	652	Sear Spring Plunger
9	610	Cartridge Lifter Actuator Hinge Pin	54	664	Slide
10	675	Cartridge Lifter Actuator Spring	55	686	Stock Assy.
11	734	†Cartridge Lifter Spring	55A	178	Initial Plate
12	689	Cartridge Lifter Spring Plunger	56	666	Stock Bolt
13	612	Cartridge Stop, R.H.	57	667	Stock Bolt Lock Washer
14	887	†Cartridge Stop, L.H.	58	668	Stock Bolt Washer
15	679	Cartridge Stop Button	59	875	Trigger
16	616	Cartridge Stop Pin	60	670	Trigger Guard
17	777	Cartridge Stop Spring, L.H.	60A	886	Trigger Guard Assy.
17A	656	†Cartridge Stop Spring, R.H.	61	671	Trigger Guard Ret. Pin
18	739	†Ejector	62	672	Trigger Guard Ret. Pin Bushing, Front
19	627	Ejector and Firing Pin Ret. Pin	63	673	Trigger Guard Ret. Pin Bushing, Rear
20	846	†Ejector Retracting Spring	64	674	Trigger Guard Ret. Pin Bushing, Ret. Spring
21	755	Extractor, R.H.	65	699	Trigger Hinge Pin
22	625	Extractor Spring, R.H.	66	874	Escapement Hook Spring
23	119	†Extractor Pivot Pin	67	685	Wood Plug
24	626	Firing Pin	69	752	Cylinder Washer
25	628	Firing Pin Retracting Spring	70	735	†(Cylinder) Wavy Spring
26	658	Forehand Assy.	70A	736	†(Cylinder) Spacer Washer
27	759	†Forehand Base	71	754	Cylinder Nut
28	631	Forehand Cap	72	11628	†Choke Click Spring
29	632	Forehand Cap Screw	73	130	†Front Sight
30	633	Forehand Cap Screw Retaining Ring	74	617	Drive Screw
31	876	†Hammer	75	402	†Pistol Grip Cap Trim
32	669	†Hammer Hinge Pin	N.I.	6610	†Receiver, Barrel and Cylinder Assy. Plain
33	641	Hammer Strut, R.H.	N.I.	6611	†Receiver, Barrel and Cylinder Assy. with Vent. Rib
34	642	Hammer Strut, L.H.	N.I.	6612	†Receiver, Barrel and Cylinder Assy. Deluxe with Choke-Control and Vent. Rib
35	643	Hammer Strut Pin			
36	762	†Hammer Spring			
37	639	Hammer Spring Guide			
38	676	Hammer Spring Retaining Pin			
39	691	Locking Pin			
40	645	Magazine Follower			
41	646	Magazine Spring			

Note: Choke Assy. does not include Choke Cage.

Note: N.I. Not Illustrated.

For Illustration — See Page 2.