

**PARTS LIST FOR**  
**J. C. HIGGINS**  
**MODELS 60 & 66**  
**12 GAUGE AUTOMATIC SHOTGUN**

**MODEL NUMBERS**

583.62 583.64 583.66  
583.63 583.65 583.67  
583.600

One of these numbers is the Model Number of your Model 60 or Model 66 Automatic Shotgun. It will be found on the left side of the barrel. Always mention this model number when communicating with us regarding the Shotgun or when ordering parts.

**PRICE LIST REFERENCE**

REFER TO THE DIVISION 6 AUTHORIZED PRICE LIST 583.00 FOR CURRENT SELLING PRICES, AVAILABILITY AND ORDERING INFORMATION.

**Filing Instructions**

Remove and destroy the Parts List Number 583.62 from the Division 6 Standard Nomenclature Grey Binder, Volume 2 and file this Revised List in its place.

**SEARS, ROEBUCK AND CO.—U.S.A.**  
**IN CANADA: SIMPSONS-SEARS, LIMITED**

Revised July, 1958

PARTS LIST FOR  
**J.C. HIGGINS MODEL 60 & 66 12 GAUGE AUTOMATIC SHOTGUNS**  
**MODEL NOS. 583.62 583.63 583.64 583.65 583.66 583.67 583.600**

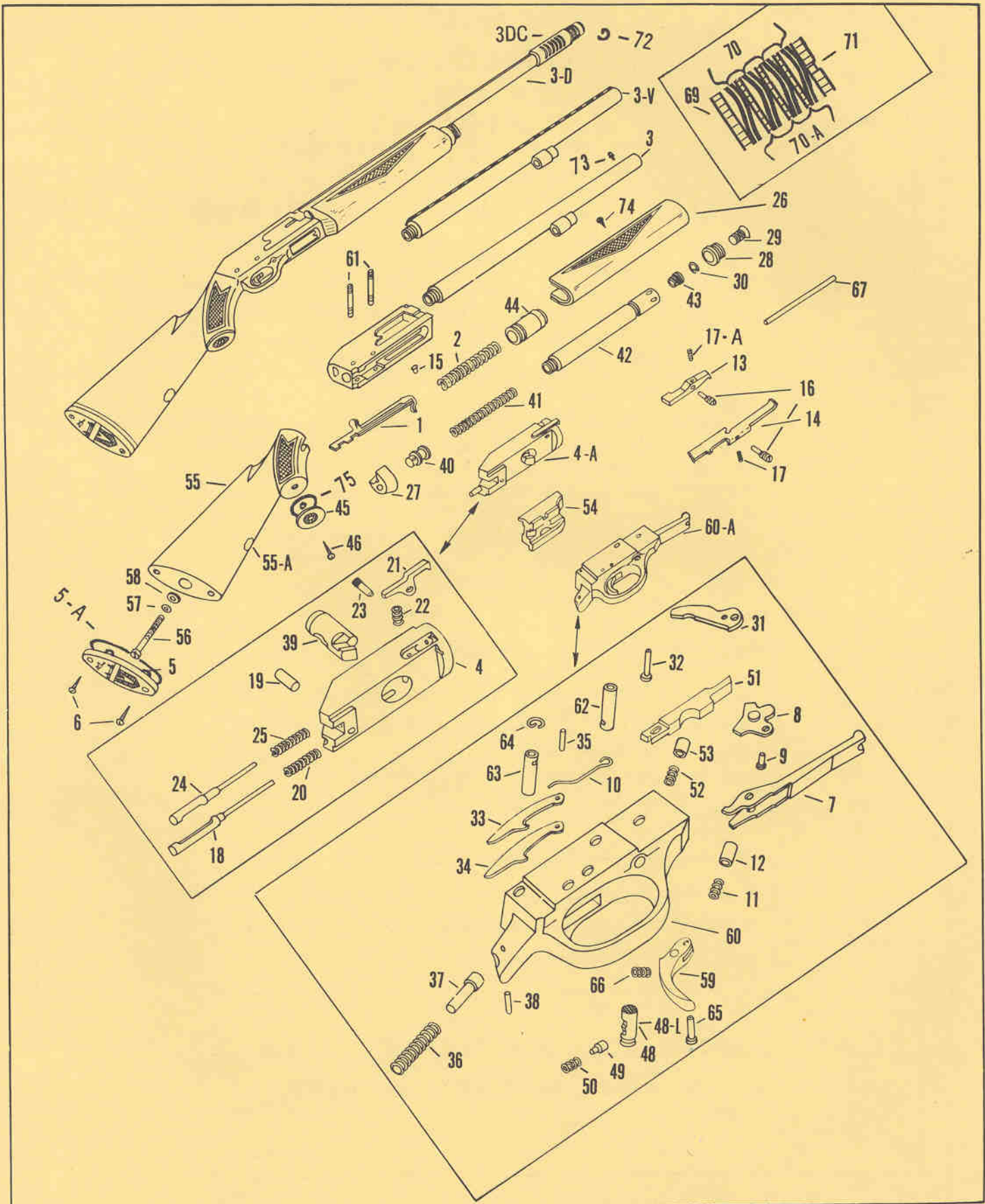

## PARTS LIST FOR

## J.C. HIGGINS MODEL 60 &amp; 66 12 GAUGE AUTOMATIC SHOTGUNS

MODEL NOS. 583.62 583.63 583.64 583.65 583.66 583.67 583.600

WHEN ORDERING REPAIR PARTS, ALWAYS GIVE THE FOLLOWING INFORMATION AS SHOWN IN THIS LIST:

1. THE PART NUMBER.
2. THE PART NAME.
3. THE MODEL NUMBER.
4. THE NAME OF ITEM.

All parts identified with a dagger (†) must be fitted to the gun by gunsmiths in Sears gunshops, or by qualified gunsmiths. Do not order repair parts by key number, always use the part number.

REF. NO.	PART NO.	PART NAME	REF. NO.	PART NO.	PART NAME
1	757	†Action Bar	39	691	Locking Pin
2	733	†Action Spring	40	645	Magazine Follower
3	866	†Barrel and Cylinder Assy. Plain	41	646	Magazine Spring
3V	867	†Barrel and Cylinder Assy. with Ventilater Rib	42	647	Magazine Tube
			43	648	Magazine Tube Cap
3D	868	†Barrel and Cylinder Assy. Deluxe with Choke Control and Ventilater Rib	44	651	Piston
			45	401	Pistol Grip Cap
			46	403	Pistol Grip Screw
3DC	769	†Choke Assy. (See Note)	48	659	Safety Button, R.H.
4	756	†Bolt		751	Safety Button, L.H.
4A	785	†Bolt Assy.	49	605	Safety Spring Plunger
5	620	Butt Plate	50	155B	Safety Plunger Spring
5A	792	Butt Plate Trim	51	771	†Sear
6	345	Butt Plate Screw	52	649	Sear Spring
7	608	Cartridge Lifter	53	652	Sear Spring Plunger
8	677	†Cartridge Lifter Actuator Assy.	54	664	Slide
9	610	Cartridge Lifter Actuator Hinge Pin	55	686	Stock Assy.
10	675	Cartridge Lifter Actuator Spring	55A	178	Initial Plate
11	734	†Cartridge Lifter Spring	56	666	Stock Bolt
12	689	Cartridge Lifter Spring Plunger	57	667	Stock Bolt Lock Washer
13	612	Cartridge Stop, R.H.	58	668	Stock Bolt Washer
14	887	†Cartridge Stop, L.H.	59	872	Trigger
15	679	Cartridge Stop Button	60	670	Trigger Guard
16	616	Cartridge Stop Pin	60A	886	Trigger Guard Assy.
17	777	Cartridge Stop Spring, L.H.	61	671	Trigger Guard Ret. Pin
17A	656	†Cartridge Stop Spring, R.H.	62	672	Trigger Guard Ret. Pin Bushing, Front
18	739	†Ejector			
19	627	Ejector and Firing Pin Ret. Pin	63	673	Trigger Guard Ret. Pin Bushing, Rear
20	846	†Ejector Retracting Spring			
21	755	†Extractor, R.H.	64	674	Trigger Guard Ret. Pin Bushing, Ret. Spring
22	625	†Extractor Spring, R.H.			
23	119	†Extractor Pivot Pin	65	699	Trigger Hinge Pin
24	626	Firing Pin	66	657	Trigger Spring
25	628	Firing Pin Retracting Spring	67	685	Wood Plug
26	658	Forehand Assy.	69	752	Cylinder Washer
27	759	†Forehand Base	70	735	†(Cylinder) Wavy Spring
28	631	Forehand Cap	70A	736	†(Cylinder) Spacer Washer
29	632	Forehand Cap Screw	71	754	Cylinder Nut
30	633	Forehand Cap Screw Retaining Ring	72	11628	†Choke Click Spring
			73	130	†Front Sight
31	770	†Hammer	74	617	Drive Screw
32	669	†Hammer Hinge Pin	75	402	†Pistol Grip Cap Trim
33	641	Hammer Strut, R.H.	N.I.	893	†Receiver, Barrel and Cylinder Assy. Plain
34	642	Hammer Strut, L.H.			
35	643	Hammer Strut Pin	N.I.	891	†Receiver, Barrel and Cylinder Assy. with Vent. Rib
36	762	†Hammer Spring			
37	639	Hammer Spring Guide	N.I.	879	†Receiver, Barrel and Cylinder Assy. Deluxe with Choke-Control and Vent. Rib
38	676	Hammer Spring Retaining Pin			

**IMPORTANT NOTE:** Some Part Numbers on earlier Model 60 Guns may differ from numbers in this list. For numbers not listed herein, refer to Price List 583.00 which includes all numbers.

Note: Choke Assy. does not include Choke Cage.

Note: N.I. Not Illustrated.

For Illustration — See Page 2.