

PARTS LIST FOR



MODEL 75
AUTO-LOADING SHOTGUN
20 GAUGE

IDENTIFICATION NUMBER

583.7501

This number is the Identification Number of your Model 75, 20 Gauge Auto-Loading Shotgun. It will be found on the left side of barrel, just forward of receiver. Always mention this Identification Number when communicating with us regarding the Model 75 Shotgun or when ordering parts.

PRICE LIST REFERENCE

REFER TO THE AUTHORIZED PRICE LIST 583.00 FOR CURRENT SELLING PRICES AND ORDERING INFORMATION.

SEARS, ROEBUCK AND CO.-- U.S.A.
IN CANADA: SIMPSONS-SEARS, LIMITED

MAY 1963

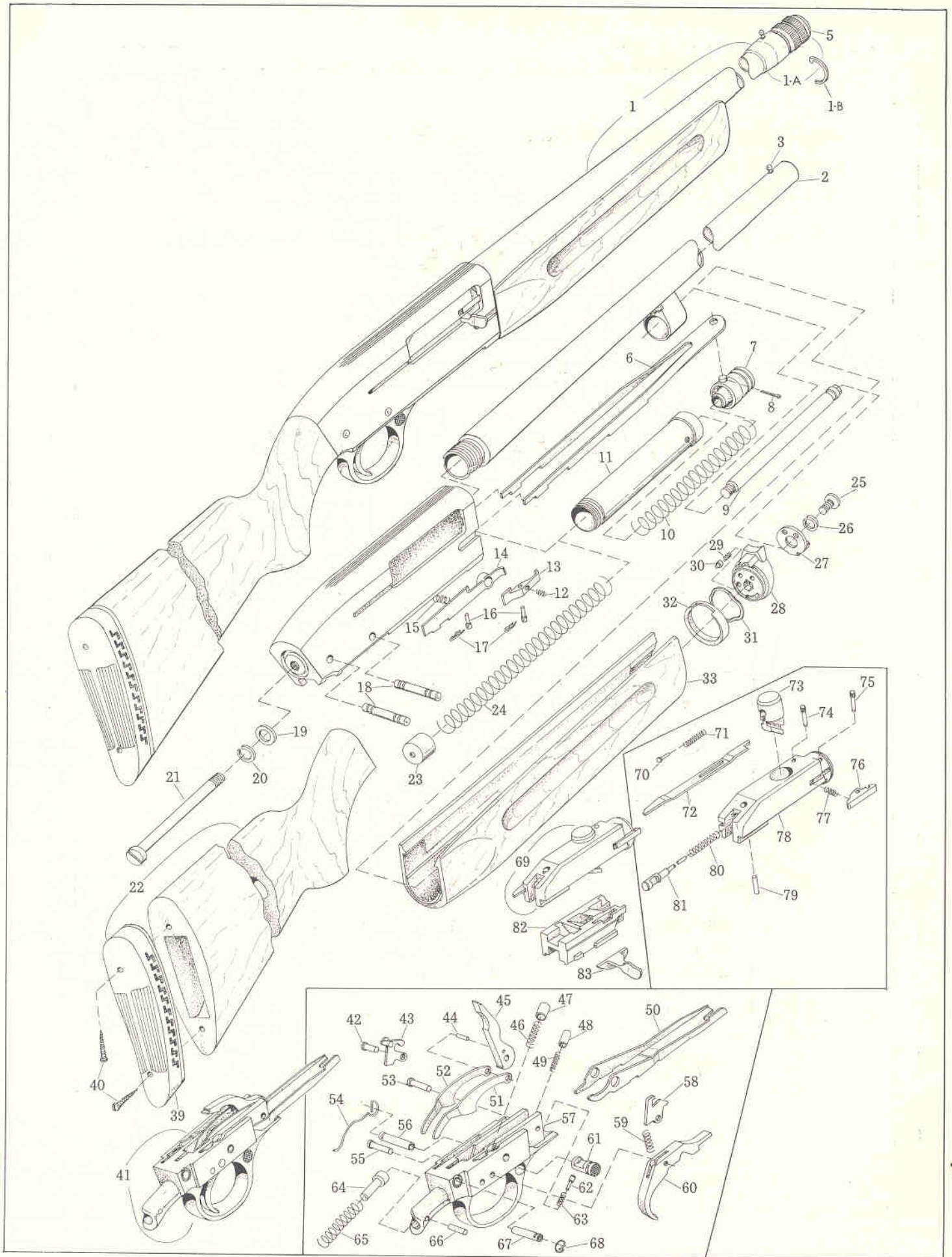

PARTS LIST FOR
MODEL 75 20 GAUGE AUTO-LOADING SHOTGUN
583.7501

WHEN ORDERING REPAIR PARTS, ALWAYS GIVE THE FOLLOWING INFORMATION
AS SHOWN IN THIS LIST:

1. THE PART NUMBER.
2. THE PART NAME.
3. THE MODEL NUMBER.
4. THE IDENTIFICATION NUMBER

All parts identified with a dagger (†) must be fitted to the gun by gunsmiths in Sears gunshops, or by qualified gunsmiths. Do not order repair parts by key number, always use the part number. When ordering barrels specify choke desired.

REF. NO.	PART NO.	PART NAME	REF. NO.	PART NO.	PART NAME
1	† 2497	Barrel & Cylinder Plain with Choke Assembly	46	897	Cartridge Lifter Spring
1A	2852	Complete Choke Assembly (Includes Element, Cap, & Click Spring)	47	689	Cartridge Lifter Spring Plunger
1B	11633	Choke Click Spring	48	652	Trigger Spring Plunger
2	† 2496	Barrel Plain (Specify Choke)	49	649	Trigger Spring
3	130	Front Sight	50	2606	Cartridge Lifter
5	11620	Choke Cap	51	641	Hammer Strut, R.H.
6	2404	Action Bar	52	642	Hammer Strut, L.H.
7	2467	Piston Assembly	53	699	Hammer Hinge Pin
8	2432	Piston Connector Lug Pin	54	675	Cartridge Lifter Actuator Spring
9	2433	Piston Rod	55	699	Trigger Hinge Pin
10	2405	Action Spring	56	2437	Trigger Guard Retaining Pin Bushing, Front
11	2466	Magazine Tube Assembly	57	2605	Trigger Guard
12	656	Cartridge Stop Spring, R.H.	58	2442	Escapement Hook
13	612	Cartridge Stop, R.H.	59	874	Escapement Hook Spring
14	2444	Cartridge Stop, L.H.	60	6662	Trigger
15	2408	Cartridge Stop Spring, L.H.	61	659	Safety Button
16	864	Cartridge Stop Pin	62	605	Safety Spring Plunger
17	865	Cartridge Stop Pin Retaining Clip	63	155-B	Safety Plunger Spring
18	2436	Trigger Guard Retaining Pin	64	639	Hammer Spring Guide
19	668	Stock Bolt Washer	65	762	Hammer Spring
20	667	Stock Bolt Lock Washer	66	676	Hammer Spring Retaining Pin
21	666	Stock Bolt	67	2438	Trigger Guard Retaining Bushing, Rear
22	2491	Stock Assembly	68	674	Trigger Guard Retaining Pin Bushing Retaining Spring
23	2445	Magazine Follower	69	† 2607	Bolt Assembly
24	2446	Magazine Spring	70	2428	Exjector Plunger
25	2425	Forehand Cap Screw	71	2411	Exjector Retracting Spring
26	2424	Forehand Screw Lock Washer	72	2439	Exjector
27	2410	Cylinder Selector	73	2418	Locking Pin
28	2421	Forehand Cap	74	2440	Exjector Retaining Pin
29	2423	Forehand Cap Plunger Spring	75	2413	Extractor Pivot Pin
30	2422	Forehand Cap Plunger	76	2604	Extractor
31	2427	Forehand Spacer	77	20723	Extractor Spring
32	2426	Forehand Ring	78	† 2603	Bolt
33	2454	Forehand	79	2414	Firing Pin Retaining Pin
39	6751	Recoil Pad	80	628	Firing Pin Retracting Spring
40	152	Recoil Pad Screws	81	2434	Firing Pin
41	2608	Trigger Guard Assembly	82	† 2615	Slide
42	2407	Cartridge Lifter Actuator Hinge Pin	83	2409	Cocking Handle
43	677	Cartridge Lifter Actuator Assembly	N.I.	751	Safety Button, L.H.
44	643	Hammer Strut Pin	00	2460	Receiver (Illustrated:-But not sold as spare part)
45	2441	Hammer	N.I.	2822	Choke Element (For Plain Barrel)
			N.I.		Not Illustrated

Note: Exjector: Denotes Extractor & Ejector